



Solid fuel boilers
Eco Logik

Solid fuel boilers

Eco Logik

- High yield GG 20 (EN-GJL-200) cast iron solid fuel boiler, fit for wood or coke combustion
- Pellet operation after assembling of the burner plate and the pellet burners Eco 3.4 P - Eco 5.5 P
- Class 3 efficiency according to EN 303-5
- Efficiency until 81% burning wood, thanks to large exchange surface of cast iron sections.
- Generous combustion chamber, until 128 dm³, which allows burning of large logs and less wood refuelling
- Adjustable smokes deflector on back flues outlet
- Stainless steel ash tray with easy front access
- Thermostatic regulator supplied as a standard
- Safety overheating device available as an optional MODEL



Eco Logik is already equipped with thermostatic regulator and chimney draught adjuster.

The first automatically adjusts boiler's temperature according to the desired setpoint, through a simple but effective mechanism.

It regulates inlet of comburent air, enhancing quality of combustion and user comfort.

Function of chimney draught adjuster is important, its correct regulation permits fuel saving, optimal thermal exchange, lower emissions and flues drying.



Best performances with Lamborghini's system

Lamborghini's pellet solutions widely comply with the most severe emission class of EN 303-5 directive I.E. Class 3.

- Class 3 EN 303-5 emission limits
- Emission ratio with Lamborghini pellet boilers

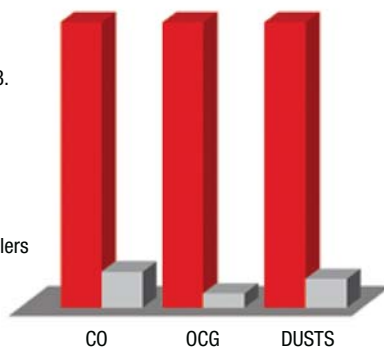

Eco Logik

Eco 3.4 P - Eco 5.5 P

Optional pellet holding tank

Lamborghini Calor offers as an option a pellet holding tank, featuring same aesthetic of the boiler.

It can be positioned on the right or left side of the boiler and features reversible top cover for pellet worm feeder insertion.

The pellet holder is in red color, coated with epoxy powder anaphoresis process.

It is available in the 195 lts capacity.

The container has been studied to permit regular and fluid supply of pellet into the motor screw and as a consequence a constant fuel feed to the burner.

Adopting a complete Lamborghini Calor system (pellet stockage, feeder, burner, boiler) means complete operation synchronisation and functionality.

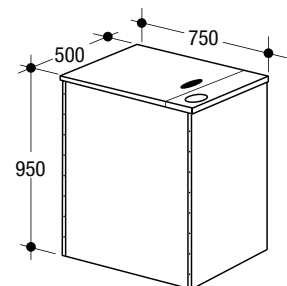

Burner

Eco 3.4 P Eco 5.5 P



- Pellet jet burner with one stage operation or modulating on 5 output steps
- Supplied with feeding motor, worm feeder assembly, connection pipes
- Pellet holding tank as an optional, capacity 195 lts
- Burner first ignition through electric heater.
- Heat request occurs through:
 - built-in timer or external (room or buffer tank) thermostat
 - built-in timer together with external (room or buffer tank) thermostat
 - programmable thermostat only (burner timer excluded)
- Solid cast aluminium frame and high-temperatures resistant stainless steel head
- Safety thermostat for flue gas back-flow, set to 85° C
- Practical pre-cabled wiring on the right of the casing, for connection to burner and system ancillaries
- Certified according to DIN EN 15270

The onboard electronic interface facilitates adjustment by the installer as regards fan's operation, screw activation, pellet loading, heating slope and output, self-diagnostic and other functions.

The user can set the internal timer according to a weekly plan, with 4 events per day.

Different combinations of pre-set weekly programs are also available for direct setting or further customisation.

Burner's switch on/off can of course occur fully manually, in case of particular or unexpected requirements of the user.



Components

Eco 3.4 P - Eco 5.5 P are supplied as a kit, in 2 cartons.

One carton with:

- 1 feeding motor
- 2 worm feeder assembly
- 3 PVC flexible feeding pipe

One carton with:

- 4 burner unit

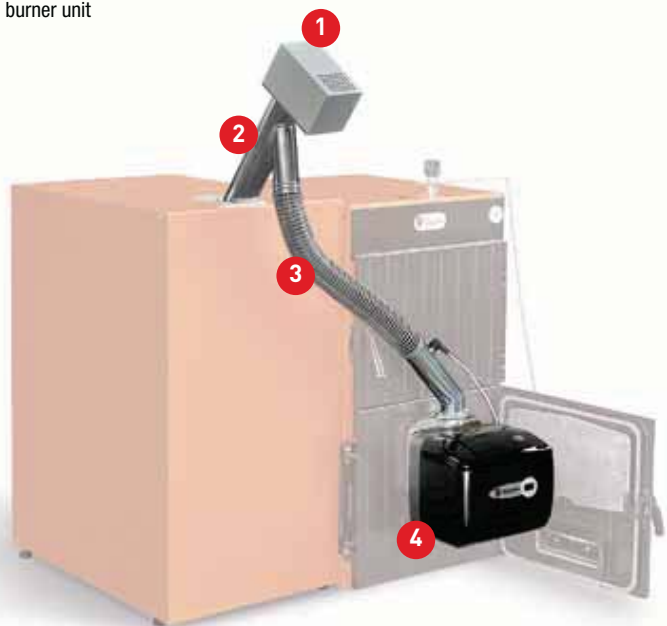



Accessories

The following accessories are available as an option.

Overheating safety valve and coil

The installation of this device is compulsory according to EN 303-5 directive. It consists in a safety valve and a coil.

The latter is an exchanger, adequately sized for each model size, to be immersed in boiler's heating water, through a proper niche.

The relief valve detects the boiler's temperature through a probe with double sensor. In case boiler's temperature reaches 95°C, the valve releases the excess heat, exchanged in the safety coil.



Pellet conversion kit

In case Eco Logik is wished to be fuelled with pellet, an optional conversion kit can be ordered and installed anytime.

A specific pellet door is to be hinged on the left side of the boiler, without removing the original wood one, which remains hinged at the right side.

The reversible pellet conversion kit is equipped with a microswitch in the package. It has to be installed on the door support and interrupts burner electric supply whenever the burner door is opened.



Double door system

Thanks to this double door system it is possible to switch retroactively fuel type with very few, quick operations, thus allowing the user to enjoy advantages of pellet and wood according to his needs, his desires and his supply of fuel. Simple and economic wood operation can be alternated whenever required with practical, clean, highly efficient, programmable pellet operation with the utmost flexibility.

Pellet



Fuel conversion



Wood



Technical data

Eco Logik Boiler

Eco Logik			3	4	5	6	7
Thermal output	Coke	kW	22,5	32,5	42,5	52,5	62,5
	Wood	kW	19,0	27,0	36,0	43,0	50,0
	Pellet	kW	22,0	30,0	36,0	42,0	48,0
Burner matching			Eco 3.4 P	Eco 3.4 P	Eco 5.5 P	Eco 5.5 P	Eco 5.5 P
Water content		l	26	30	34	38	42
Chamber content		dm ³	48	68	88	108	128
Depth (L)		mm	510	620	730	840	950
Chimney diameter (A)		mm	150	150	150	180	180
Minimum draught at stack	Coke	Pascal	8	10	15	20	25
	Wood	Pascal	12	14	16	18	20
	Pellet	Pascal	23	25	25	25	25
Dimension door		mm	384x210	384x210	384x210	384x210	384x210
Operating pressure		bar	4	4	4	4	4
Weight		kg	193	241	289	337	385
a1	System delivery						
a2	System return						
a3	System drain						
a4	Flue						
a5 - a6	Safety coil connection						
a7	Safety coil sheath connection						

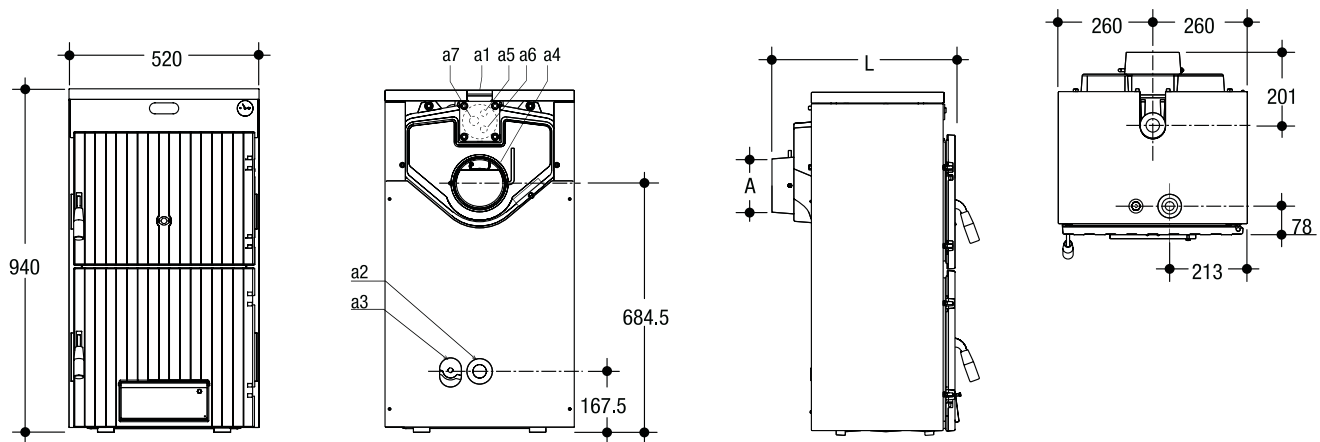

Eco 3.4 P - Eco 5.5 P Burner

Eco			3.4 P	5.5 P
Output	max.	kW	34,1	55,0
	min.	kW	13,7	30,0
Flow rate	max.	kg/h	7,2	11,6
	min.	kg/h	2,9	6,3
Electrical protection rating	IP		X0D	X0D
Power voltage/frequency	V/Hz		230/50	230/50
Electrical power input	W		50	70
Igniter electrical power	W		300	300
Empty weight	kg		11	19
Pellet dimensions	Ø/length	mm	6/35	6/35

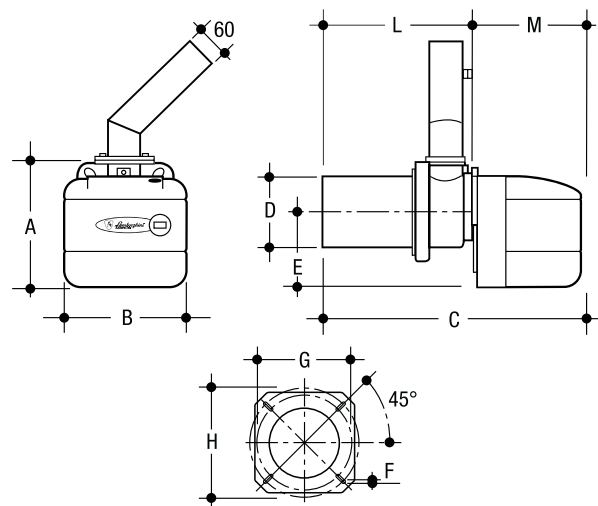

	A	B	C	Ø D	E	F	Ø G	Ø H	L	M
Eco 3.4 P	238	250	514	139,7	144	M8	180	204	295	219
Eco 5.5 P	300	280	580	168	175	M8	210	234	343	235

hurlcon hydronic heating
naturally better

Lamborghini Calor S.p.A.
via Statale 342 - Casella Postale 46
44047 - Dosso - (Ferrara) - Italy
Tel. Italia 0532.359.811 - Tel. Export 0532.359.913
Fax Italia 0532.359.952 - Fax Export 0532.359.947
www.lamborghinicalor.it - info@lamborghinicalor.it



Lamborghini
CALORECLIMA

Quality Management System certified
according to UNI EN ISO 9001